

PRODUCT INFORMATION



07/2018, 6.5
Aftersales/Parts and Accessories/Roof Rack/Transport System/Trailer tow hitches
Pl: SZ_015_02_14

ORIGINAL BMW ACCESSORIES. Pro 2.0 Rear Bicycle Carrier for Ball Head. Suitable for All Series.

NEWS:

- Product information revised

Product description

This easy to use rear bicycle carrier is fitted with removable retaining arms, can be loaded as standard with two bicycles or e-bikes and is also suitable for transporting fat bikes with its new, extra long cog belt (available as an option).

Sales features / benefits

- **NEW:**
 - Optional, **extra** long cog belts available for transporting fat bikes.
- **Simple installation:** The wheels are secured **using** a ratchet system. **Single-handed control** of the ball head clamping system.
- **Easy to use:** The wheel rails are extended using two handles.
- **Quick fastening system** for locking the support clamp.
- Removable retaining arms can be **freely** positioned.
- Bicycles with an axle spacing of **up to** 130 cm can be transported.
- Satisfies the **very highest** quality and safety requirements.
- **High** payload of 2 x 30 kg bicycle weight.
- **Lightweight**, yet **strong** and **very** durable.
- Fold-down function for **easier** access to the rear.
- **Adjustable** lights.
- Includes **universal** number plate holder.

Cross-selling

- Long cog belt for fact bikes (82 72 2 459 968)
- Extension for 3rd wheel rail (82 72 2 287 888)
- Black transport bag, extending, also suitable for use with the 3rd wheel rail (82 72 2 289 653)
- Sectioned access rail for easier loading, including suitable bag (82 72 2 295 787)
- Original BMW retrofit trailer tow hitches (see EPC)
- BMW Lifestyle bicycles and E-bikes

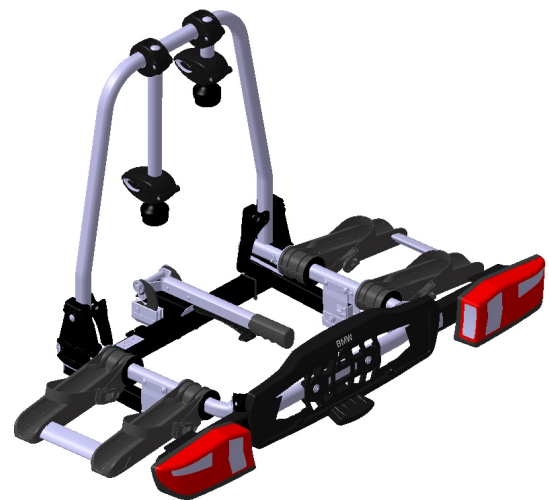

Pro 2.0 rear bicycle carrier.

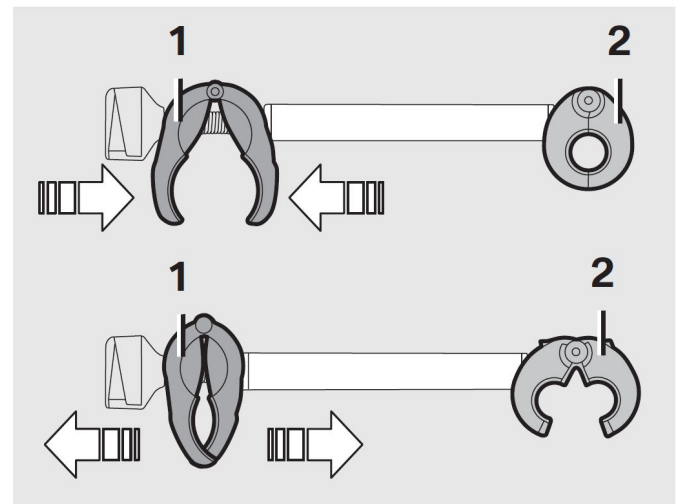

Diagram of removable retaining arms.

Content/validity

Please note that the purpose of the product information is solely to provide advance information about new products.

Before ordering, always verify the stated parts numbers in the ETK. Only the ETK provides the currently valid information.

Complete price package

For a detailed proposal preparation, look for the complete price package on the KSD DVD.

Please obtain the applicable prices from your pricing system or from the pricing publications with which you are familiar.

Pro 2.0 Rear Bicycle Carrier for Ball Head. Suitable for All Series.

Technical data

- Dimensions (L x W x H) **without** 3rd wheel rail fitted:
 - Folded: 640 x 640 x 243 mm
 - Open: 640 x 1190 x 745 mm
- Weight without the 3rd wheel rail fitted: approx. 14 kg
- Wheel rail spacing: 220 mm
- Bicycle length (with central alignment) from 720 mm to 1300 mm axle spacing (front axle to rear axle on bicycle)

Additional parts required

Exhaust heat shield

| | |
|---|-----------------|
| Cars with a high exhaust system (see EPC for more information) | 82 72 2 344 298 |
| F25, F26 (see EPC for more information) | 82 72 2 406 792 |



Notes:

Note:

- On cars with a high exhaust system (for example X5 and X6) or on the X3 and X4, an exhaust heat shield must be installed on both sides (see "Additional parts required").
- Also suitable for rear luggage carrier option preparation (SA 3AR) with rear ball head carrier (see EPC). ◀



Safety information:

- Loose fitted bicycle components (for example battery pack, panniers, baskets, child seats, etc.) must be removed before setting off.
- Before fitting the carrier on the trailer tow hitch, the relevant cleaning materials must first be used to ensure that the ball and the clamp system are free from oil and grease.
- By fitting the 3rd wheel rail and the resulting longer lever arm, the overall payload capacity of the rear carrier reduces from 60 kg to 52 kg. ◀

Installation time

- Around 5-10 minutes for the first time if fitted by the customer.
- Around 2 minutes are required for each subsequent fitting.

Installation information

| | |
|--|-----------------|
| Pro 2.0 rear bicycle carrier and extension kit for a 3rd bicycle | 01 29 2 287 889 |
| Exhaust heat shield | 01 29 2 287 882 |

Part number

| Name | Availability/ EPC DVD | Part number |
|-------------------------------------|--------------------------|-----------------|
| Pro 2.0 rear bicycle carrier | | |
| LHD (left-hand drive) | 05/2014 | 82 72 2 287 886 |